

## Urban plot of land with building permission & project in a perfect location with sea views, near Lagos

PLOT IN LAGOS

ref. **LG2168**  
**725.361€**



### Location +

Town	Lagos
Parish	Lagos (São Sebastião e Santa Maria)
Municipality	Lagos, Faro
Region	Algarve (West)

### Details +

Usage	Residential
Type	Plot

### Areas +

Plot Area	3.015 m²
-----------	----------

### Access +

- Exclusive with TogoFor Homes
- Plot 3015m²
- Close to the popular city of Lagos with all amenities
- The project costs are already included in the purchase price
- Distance to the beach 1km

The property is located in a popular urbanization between Lagos and Portimão, not far from a golf course and the beach. It is one of 2 properties still available, out of a total of 7, located next to each other.

There is already an approved project for a 3 bedroom villa. The costs for the project approval are already included in the purchase price, the fees for the building license are not included in the purchase price. The building license must be applied for to begin construction.

You can also buy the land and create your project with an architect. We can recommend architects and builders to you. If desired, it is also possible to have the construction carried out with the approved project through the provider. If you want the provider to realize the project, you will also save the time from application to approval of 6-8 months.



## YOUR PROPERTY SPECIALISTS

Tarmac

### Water-Electricity-Drainage +

Mains drainage, Mains water, Mains electric

### Garden +

Fenced

### Views +

Countryside View, Panoramic View, Sea View

### Extra Features +

Building Plots

For more information please contact us. We explain all the options to you during an on-site visit.

Plot:

- Some Sea views
- Asphalted driveway
- City electricity, water and sewage connections are already on the property

### Amenities

- Asphalted driveway
- Mains supply is already available on the plot

### Location

- Distance to nearest beach: 1km
- Distance to nearest school: 2km
- Distance to nearest golf course: 1km
- Distance to nearest town: 1.5km
- Distance to Faro International Airport: 80km



Lagos Office - ALGARVE:

Marina de Lagos, Edifício Astrolábio, Lote 24-Loja 5  
GPS. 37° 6' 41.85" N - 8° 40' 30.251" W

Togofor Homes - Sociedade Mediação Imobiliária, LDA | License: AMI 6902

+351 282 476 568

enquiries@togofor-homes.com

[www.togofor-homes.com](http://www.togofor-homes.com)



YOUR PROPERTY SPECIALISTS

## PHOTO GALLERY



*Possible Project*

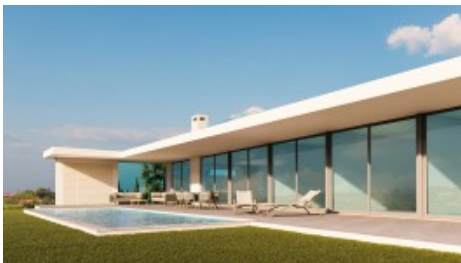

*Possible Project*



*Possible Project*

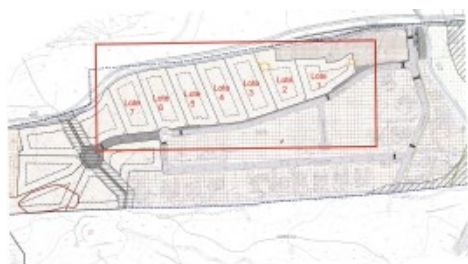

*Plots*



*Lagos Meia Praia*



*Lagos Ponta da Piedade*



*Lagos Marina*



Lagos Office - ALGARVE:  
Marina de Lagos, Edifício Astrolábio, Lote 24-Loja 5  
GPS. 37° 6' 41.85" N - 8° 40' 30.251" W

Togofor Homes - Sociedade Mediação Imobiliária, LDA | License: AMI 6902

+351 282 476 568  
enquiries@togofor-homes.com  
**www.togofor-homes.com**